

# EUROA STREETSCAPE RENEWAL PROGRAM

Concept Plan [DRAFT]  
Prepared by About Architecture for Strathbogie Shire  
August 2021





## **PROJECT BACKGROUND**

Within the 2020/21 budget, the Strathbogie Shire Council approved funding for works to be undertaken to renew and improve existing streetscapes within the shire.

This allocation has been supported by a grant from the Federal Government.

Effective streetscape design is an integral part of shaping a community's identity, increasing civic pride and improving a sense of well-being and belonging. Areas for improvement may include but are not limited to; town entry features, street furniture, planting, pedestrian/traffic circulation and safety, public art, lighting, general wayfinding and signage.

## **PURPOSE OF THIS DOCUMENT**

This document presents a conceptual streetscape renewal plan for the town of Euroa.

The intention of this streetscape renewal plan is to provide a visual guide for future streetscape development, rather than a literal or specific representation of works to be completed.

The recommendations include streetscape projects which can be implemented progressively as well as a palette of streetscape materials, finishes, fixtures and landscaping recommendations that work to maintain streetscape consistency, improve functionality and amenity and reflect a sense of identity and character for the area.

The project concentrates on the public realm, which includes the components of the streets and footpaths. Building facades are not included.

## **STUDY AREA**

The focus of the study area is the town centre of Euroa, defined by Binney Street.

The study area includes intersections at Brock and Railway Streets.



KEY QUALITIES & STREETSCAPE CHARACTER

*Waterways envelope and meander around the town and through local parklands. Tree lined streets provide a tranquil and relaxed feel.*

*Nestled at the base of the Strathbogie Ranges and characterised by its ever present views to Balmattum Hill, the town has constant links to its surrounding environment.*

*As Euroa continues to develop, streetscape renewal should reflect and celebrate its surrounds while respecting its historic village atmosphere.*



Balmattum Hill



Hlstric Buildings



Wide Verandahs (Albeit a bit run down)



Pedstrian Friendly



Wide Pavement Area



Good existing street structure



AREA FOR IMPROVEMENT & ADVERSE VISUAL IMPACTS



**Pavement Surface Damage**  
Existing tree root structures have caused significant damage to the pavement surface. Opening this surface area to allow for low level planting and permeability to roots is key to streetscape development



**Excess Concrete**  
Missed opportunities for landscaping



**Short Term Fixes that have become permanent**  
Temporary and unappealing tree guards



**Non-Descript Seating**  
Lacks any sense of identity or character



**Other street fixtures**  
Non-descript and generic fixtures that need a refresh



**Surface Patches**  
Over the years the surface has required repairs and maintenance. These patches have now become visually distracting and unappealing



**Surface Drainage**  
Pooling and water settling occuring due to the uneven nature of the pavement surface



**Service Pits**  
Low level of care in placement and repairs.



# DESIGN ELEMENTS

[DRAFT]

Prepared by About Architecture for Strathbogie Shire  
August 2021

MATERIAL PALLETTE

INFLUENCE



PATHS, PAVEMENTS

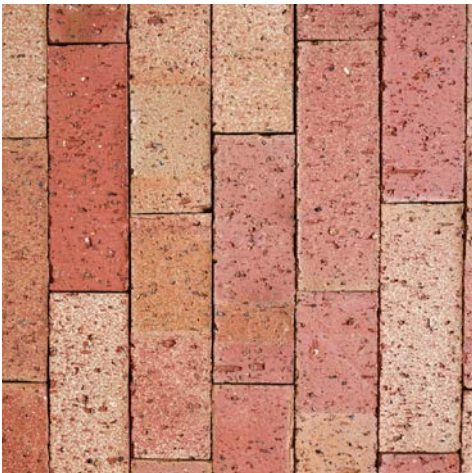

**PEDESTRIAN ZONE**  
Littlehampton Old Red Paver  
Permeable



**BUS ZONE**  
Coloured Concrete  
Colour: Wilderness



**PAVEMENT**  
Exposed Aggregate Concrete  
Colour: Southern Cross



**PAVEMENT**  
Exposed Aggregate Concrete  
Colour: Bacchus Marsh

EDGES & FENCES



**CARPARKING (Driving Area)**  
Drivecon Permeable Concrete  
Colour: Papyrus



**CARPARKING (Parking Area)**  
Grass Crete



**PROPOSED**  
Predominant Use:  
Garden Bed Edges



MATERIAL PALLETTE

KEY MATERIALS



MILD STEEL, SEALED



POWDERCOATED  
TEXTURED BLACK/DARK GREY



LOCAL GRANITE



LOCAL HARDWOOD TIMBER

SHADE STRUCTURES



**PROPOSED**  
Examples  
**Location:** Post Office, Front of Old Gambles Nursery Site  
**Key Attributes:** Organic Shape, Mix of covered and shaded area.  
**Key Material:** Steel, Timber



EVENT SPACE



**PROPOSED**  
Examples  
**Location:** Post Office  
**Key Attributes:** Raised  
**Key Material:** Timber



SEATING



**REGULAR CURVED SEATING**  
Mild Steel & Hardwood Timber  
Back Support & Non-Back Support  
Options



**REGULAR CURVED SEATING**  
Mild Steel & Hardwood Timber  
Back Support & Non-Back Support  
Options  
Integrated into planter boxes



**STRAIGHT SEATING**  
Mild Steel & Hardwood Timber  
Non-Back Support



**STRAIGHT SEATING**  
Mild Steel & Hardwood Timber  
Back Support



MATERIAL PALLETTE

OTHER STREET FIXTURES



**BIKE RACK**  
Example  
**Key Attributes:** Simple  
**Key Material:** Steel



**BOLLARD**  
Example  
**Key Attributes:** Simple  
**Key Material:** Steel



**BINS**  
Example  
**Key Attributes:** Dog Bags  
**Key Material:** Steel, Timber



**DRINKING**  
Example  
**Key Attributes:** Bowl Refill, Bottle Refill & Bubbler  
**Key Material:** Stainless Steel, Timber

OTHER STREET INITIATIVES



**USB CHARGING**  
Integrated into Seating



**EV CHARGING**  
In Car Parking Areas

OTHER STREET ACTIVITY



**OUTDOOR BOOK STORAGE**  
Example Only  
Facilitating existing street activity  
Location: Already Read Bookshop



**PLAY**  
Example Only  
Facilitating & encouraging play



**PLAY**  
Example Only  
Facilitating & encouraging play



**PLAY**  
Example Only  
Facilitating & encouraging play



LANDSCAPING



**LOW LEVEL PLANTING EXAMPLES**  
Lemon Beauty Heads, Wingless Bluebush, Nodding Saltbush, Woolly New Holland Daisy, Common Wheatgrass, Westringia Fruticosa, Lomandra Tanika, Ficinia Nodosa, Kangaroo Grass, Lomandra longifoia, Lomandra 'lime light', Wattle Mat-Rush, Juncus psammophilus, Pycnosaurus globulus, Drumsticks, Woolly grevillea – prostrate form, Acacia mitchellii, Bristle Wallaby Grass, Common Everlasting, Kidney Weed, Weeping Grass



**SHRUB EXAMPLES**  
White Correa, Wyeena Flax Lily, Mallee Wattle, Gold-dust Wattle, Golden Wattle, Sweet Bursaria

LANDSCAPING REFERENCE GUIDE

Refer to the Ecological Vegetation Class Bioregion Benchmark for Vegetation Quality Assessment in the Victorian Riverina bioregion. EVC 55\_62: Riverina Plains Grassy Woodland (syn. Plains Woodland)

This streetscape renewal concept incorporates a mix of local indigenous plantings to improve local biodiversity, promote sustainable local plantings and provide a sense of identity and connection to place through the landscape approach. The use of local and indigenous plantings has many benefits including local availability, environmental tolerance, reducing the effects of climate change and improved water use. The additional benefit of involving existing community groups (that have interest and expert knowledge in conservation, land care and their local environment) into the plant selection process, has the ability to also see this landscaping approach thrive.

OTHER LANDSCAPING TREATMENTS



**LANDSCAPING ROCKS**  
Predominant Use: Mixed in with low-level planting areas



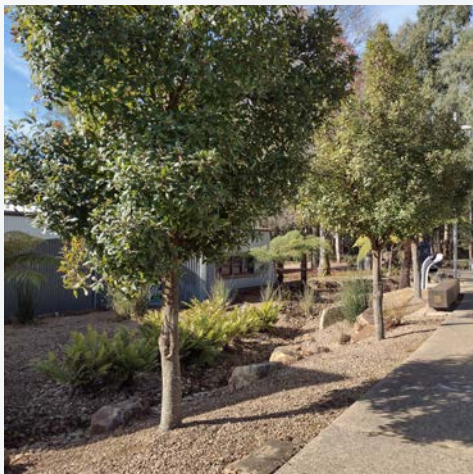

**MEDIUM TREE EXAMPLES**  
Tristanopsis laurina 'Luscious',  
Eucalyptus mannifera 'Little  
Spotty', Lemon Squash Corymbia  
citriodora, Corymbia citriodora  
'Scentuous' syn. 'Dwarf Pink',  
Acacia implexa - Hickory Wattle,  
Lightwood, Weeping Pittosporum



**LARGE TREE EXAMPLES**  
Eucalyptus leucoxylon  
megalocarpa, Brachychiton  
populneus, Lophostemon  
confertus



LIGHTING



**REPLACEMENT FOR EXISTING OVERHEAD ROAD LIGHTS**  
Replace & add additional, providing structure for event lighting and seasonal decorations



**REPLACEMENT FOR EXISTING HERITAGE POLE LIGHTS**  
To replace the existing heritage pole lights at existing crossing points



**UPLIGHTING**  
In-ground spikes to uplight trees



**LOW LEVEL LIGHTING**  
Located in low level planting areas and down laneways. Could also be integrated into bollards

SIGNAGE



**EXISTING STORYTELLING**



**EXISTING MAP SIGNAGE**

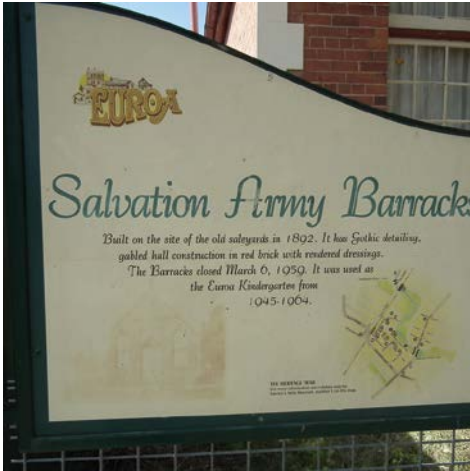

**EXISTING POINT OF INTEREST**



**EXISTING DIRECTIONAL**

PROPOSED

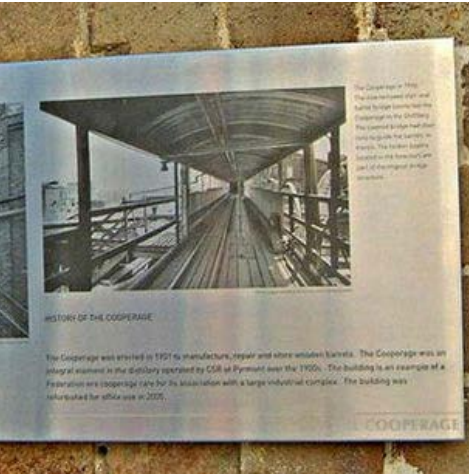

**PROPOSED HERITAGE STORYTELLING**  
Examples  
**Location:** As Per Heritage Trail  
**Key Attributes:** Key Images, Consistent text type with other signage. Possible accompaniment of qr code linking to additional photos and audio description  
**Key Material:** Etched steel. Muted grey tones.



**PROPOSED MAP SIGNAGE**  
Example  
**Key Attributes:** Map of the Area, Covered Area, With Lights  
**Key Material:** Timber  
**Location:** Car Parks



**PROPOSED DIRECTIONAL**  
Example  
Direction to public toilets, car-parking, walks  
**Key Attributes:** Simple, Clear, Minimal, With Lights  
**Key Material:** Metal



# STAGE ONE

[DRAFT]  
Prepared by About Architecture for Strathbogie Shire  
August 2021



STAGE ONE - EXISTING CROSSING RENEWAL

*The first stage of the streetscape renewal plan aims to deliver a portion of the project in the immediate term which utilises an existing funding agreement with the Federal government.*

*The following describes this stage of the streetscape renewal plan and the initial steps required to see it implemented.*

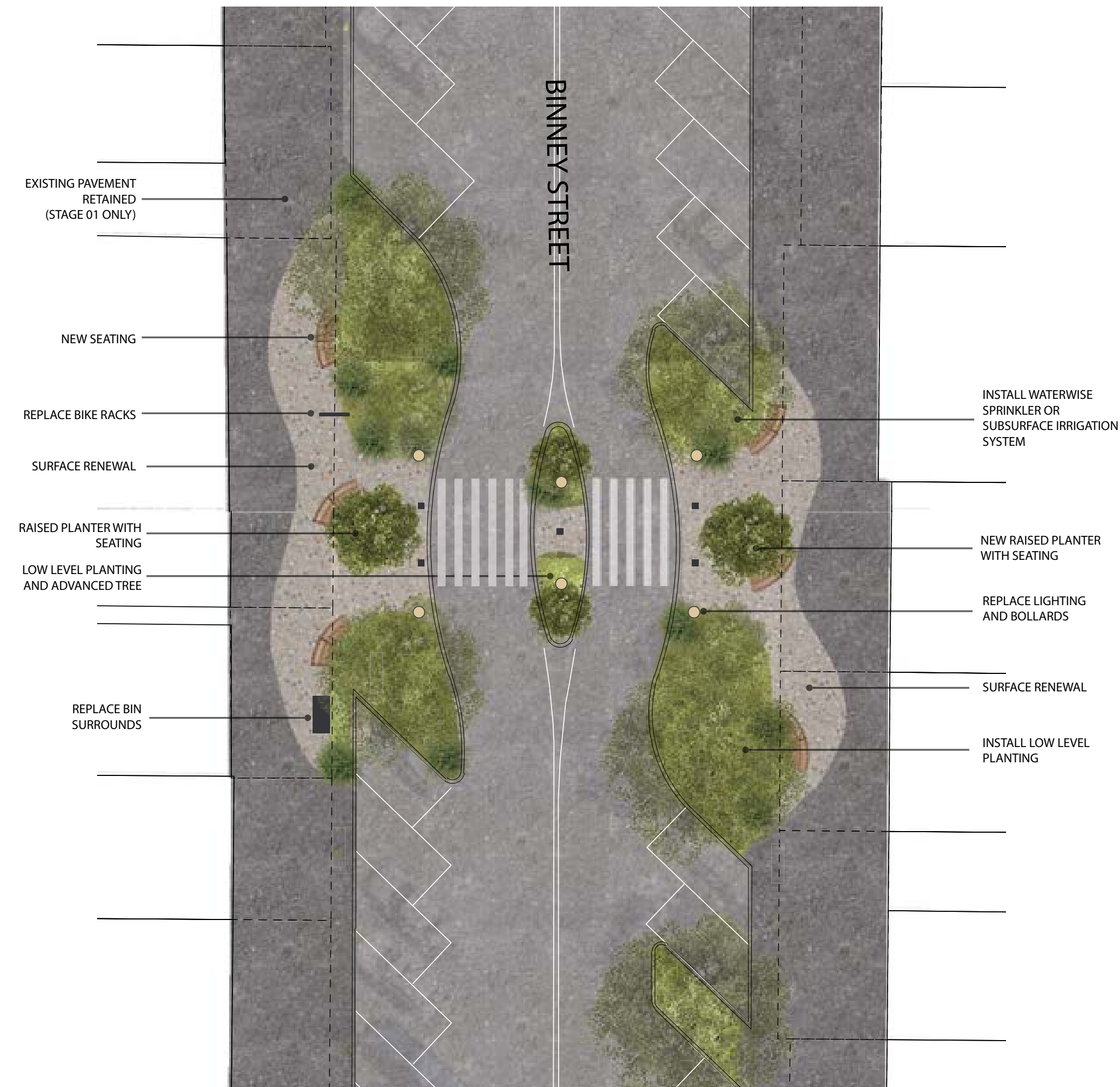



STAGE ONE - EXISTING CROSSING RENEWAL

DELIVERABLES

- Repair & clean of kerbing
- Removal of damaged pavement surface in preparation of low level planting
- Installation of waterwise irrigation system
- Installation of surface drainage systems at appropriate locations
- Provision of underground power supply for inground lighting
- Preparation of soil for planting
- Installation of bark/ground cover and feature granite rocks
- Installation of advanced trees and low level planting
- Installation of new seating, bike racks, bin surrounds and planter boxes
- Installation of new pavement surface to the area (consideration of permeable concrete)
- Replacement of existing lights (taller than existing) and bollards as per material palette
- Zebra pedestrian crossing
- Installation of sculptural signage





**STAGE ONE - COMMUNITY INVOLVEMENT & IMPLEMENTATION**

*Involvement and engagement with local groups is key to achieving the best outcome for the streetscape renewal program.*

*Community groups in Euroa such as the Euroa Arboretum, Friends of the Sevens and the Euroa Community Action Group can provide a wealth of knowledge and understanding of desired local outcomes in particular to plant selection and long-term maintenance strategies.*

*Other community groups with interest in arts and culture can provide a local voice and identity to furniture design, signage design and identified art opportunities.*

*Engaging the skills of these groups and their networks within the community as part of the implementation process will improve;*

*Knowledge Transfer*

*Local Wealth Transfer*

*Community Involvement*

*Site Specific and Appropriate Outcomes*

*Community Ownership*

*Community Socialisation & Well-Being*